

VIA EMAIL: rsagala@gpinet.com

October 24, 2017

Mr. Robert Sagala, Jr.
Project Manager
GPI Greenman – Pedersen, Inc.
400 Rella Boulevard, Suite 207
Montebello, NY 10901

One Larkin Center
Yonkers, New York 10701
Tel. 914 376-8008
Fax 914 376-8621
jcarr@yonkerspublicschools.org

Dr. Edwin M. Quezada
Superintendent of Schools

John P. Carr, P.E.
Director of Facilities III
School Facilities Management

**Re: RFP 420-17-05 for Professional Architectural/Engineering Services for
Public School 30 Replacement of Exterior Doors, Windows, Site
Improvements, and 5 Classroom addition Project, YPS #10732**

Dear Mr. Sagala:

After considerable review, this is to accept the terms and conditions of the GPI proposal dated September 13, 2017, GPI YPS-0004, JO No. 17400.00, attached. The basis of which proposes an additional \$86,900.00 in fees to cover the additional work required in order to separate the total of CIP work at School 30 into the “Reconstruction” and “SSBA” phases and bids.

This is being presented to the Board of Education for their concurrence at their stated meeting to be held on November 15, 2017.

None of the amendments proposed have any effect on the current work and only impact later phases of GPI’s work such as Bidding and Negotiation, and Construction Support. Therefore, this amended task is no cause for delays or pauses in the work already undertaken by GPI.

If you should have any questions please do not hesitate to call me at (914) 376-8008.

Very truly yours,



John P. Carr

cc: K. Meyer, GPI
L. Pavone
J. Becker
L. Piltz
J. Hubbard

GPI Greenman - Pedersen, Inc.

Engineering and Construction Services

September 13, 2017

YPS-0004
JO No. 17400.00

Mr. John Carr, Executive Director-Schools Facilities Management
Yonkers Public Schools
One Larkin Center
Yonkers, New York 10701

Subject: Proposal for Additional Architectural/Engineering Design Services for
Restoration of Building Envelope, Exterior Windows and Doors, Site, Security,
Asbestos Abatement and 5-Classroom Addition at School 30, Nevada Place,
Yonkers NY

Reference: RFP No. 420-17-06 dated April 4, 2017 & GPI Proposal "YPS-0001" dated May
3, 2017

Dear Mr. Carr:

Greenman-Pedersen, Inc. (GPI) is pleased to submit this proposal to the Yonkers Public Schools (YPS) for the subject professional services.

The following information is provided as attachments to this letter:

- * Attachment I- Scope of Additional Services
- * Attachment II - Fee Proposal

Thank you for your consideration. If you have any questions, or if further information is required, please do not hesitate to call.

Very truly yours,

Robert Sagala Jr.
Project Manager - GPI

RJS:rjs
JBecker (YPS)
ESchneider
attachments

cc: Job Book – COY

Attachment I

Proposal for Additional Professional Services Associated with
Restoration of Building Envelope, Exterior Windows and Doors, Site, Security, Asbestos
Abatement and 5 Classroom Addition at School 30, Nevada Place, Yonkers, NY

6. Two Construction Phases, duplicate submittals and review e.g. windows, doors, hardware, misc. HVAC / electrical, duplicate RFI's, Duplicate Site Visits, Field Reports, Meetings, Minutes, Duplicate Payment App Reviews, Duplicate Punch Lists, Substantial Completion Inspections, and Final Inspections.
7. Multiple smaller projects would normally have a higher fee percentage than one larger project.
8. General Conditions and Overhead double as the time frame doubles. Schedules, Administration, Project Management.

Designs will be in accordance with all Federal, State (State Education Department, S.E.D.), County and local codes and regulations. The GPI team will complete, submit, and follow to approval all forms and paper processes required by the New York State Education Department from the LOI to project closeout including all Change Orders and Certificates of Substantial Completion (CSC).

FED. RD. RES. NO.	STATE	FEDERAL AID PROJECT NO.	SHEET NO.	TOTAL SHEETS
####	NEW YORK	####	5	—
CONCEPTUAL PLANS				
S.I.N. ####				

- NOTES:**
1. PROPOSED PEDESTRIAN WALKWAY TO SCHOOL GYM FOR ASSEMBLY.
 2. PROPOSED SCHOOL DRIVEWAY FOR ADDITIONAL DROP-OFF AND PICK-UP AREA FOR STUDENTS IS APPROXIMATELY 200 FEET LONG. IT CAN POTENTIALLY ACCOMMODATE (6) 15-FOOT-LONG SCHOOL BUSES OR (16) PRIVATE VEHICLES.
 3. EXPANSION OF EXISTING STAFF PARKING LOT WOULD INCREASE FROM 20 PARKING SPACES TO 65 SPACES.
 4. EXISTING GARAGE LOT CUMMAN SCHOOL DRIVEWAY CAN BE CONVERTED TO 4 ADA-ACCESSIBLE PARKING SPACES.
 5. EXISTING DRIVEWAY WILL SERVE AS ADA-COMPLIANT ENTRANCE FOR P310.

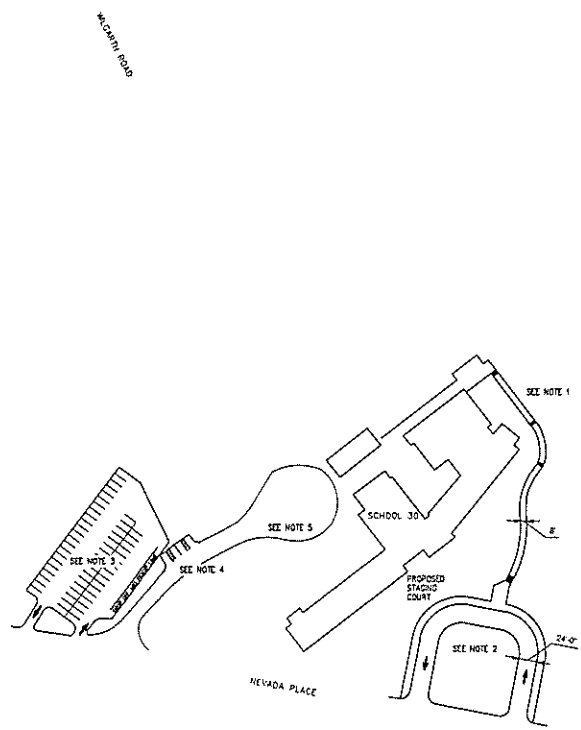

The name of the project is YONKERS PUBLIC SCHOOLS, PROJECT NO. 616057, SHEET NO. 5 OF 5. THE PROJECT IS A CONCEPTUAL PLAN FOR THE PROPOSED STAGING COURT AND PARKING AREAS AT SCHOOL 30. THE PROJECT IS A CONCEPTUAL PLAN FOR THE PROPOSED STAGING COURT AND PARKING AREAS AT SCHOOL 30. THE PROJECT IS A CONCEPTUAL PLAN FOR THE PROPOSED STAGING COURT AND PARKING AREAS AT SCHOOL 30.

DESIGNED BY: [Name] CHECKED BY: [Name]
 ESTIMATED BY: [Name]

GPI Greenman-Pedersen, Inc.
 Engineering and Construction Services
 115 West Main Street, Boston, NY 11703
 Tel: (815) 587-5400 Fax: (815) 587-5405

PURCHASE ORDER: 616057			
YONKERS PUBLIC SCHOOLS			
OPTION 5			
DWG NO.	SCALE	DATE	SHEET
—	1" = 60'	—	5

Attachment II
Proposal for Additional Professional Services Associated with
Restoration of Building Envelope, Exterior Windows and Doors, Site, Security, Asbestos
Abatement and 5 Classroom Addition at School 30, Nevada Place, Yonkers, NY

FEE PROPOSAL

The services identified in the Scope of Services (Attachment I) will be provided for a total fee of:

Phase 1 – “Reconstruction” - \$ 268,100 (Two-Hundred and Sixty-Eight Thousand and One Hundred Dollars) inclusive of the following reimbursable expenses:

- \$ 20,000 (Five Thousand Dollars) for reimbursables.

Phase 2 – “SSBA” - \$ 268,100 (Two-Hundred and Sixty-Eight Thousand and One Hundred Dollars) inclusive of the following reimbursable expenses:

- \$ 20,000 (Five Thousand Dollars) for reimbursables.

Breakdown of fees presented above with regards to the previous fee submitted and approved as part of YPS-001 proposal is below:

Task	Original Fee	Phase A	Phase B	Total	Difference
SD	\$129,000	\$64,500	\$64,500	\$129,000	\$0
DD	\$101,500	\$50,750	\$50,750	\$101,500	\$0
CD / SED	\$81,600	\$49,800	\$49,800	\$99,600	\$18,000
Bidding / Negotiation	\$8,100	\$12,550	\$12,550	\$25,100	\$17,000
Construction Support	\$81,000	\$65,500	\$65,500	\$131,000	\$50,000
Close Out	\$8,100	\$5,000	\$5,000	\$10,000	\$1,900
Sub-Total	\$409,300	\$248,100	\$248,100	\$496,200	\$86,900
Reimbursables	\$40,000	\$20,000	\$20,000	\$40,000	\$0
Grand Total	\$449,300	\$268,100	\$268,100	\$536,200	\$86,900