



Yonkers Public Schools: Public School 30
June 20th, 2017





Goals

- Create additional space for classrooms through cost effective and 'green' or sustainable construction methods
- To be constructed without disturbing the day to day life of the students and teachers who inhabit the building during the school year and eliminate the existing modular building.
- Strive for sustainable design and construction methods that are eco-conscious and economical.

Yonkers Public Schools: Public School 30

Schematic First Floor Plan

SQUARE FOOTAGE DATA			
	EXISTING	PROPOSED	TOTAL
FIRST FLOOR	25,149	5,521	30,670
TOTAL FINISHED AREA	25,149	5,521	30,670

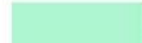
LEGEND	
	PRE-K
	CLASSROOM
	ELEVATOR/MECHANICAL ROOM

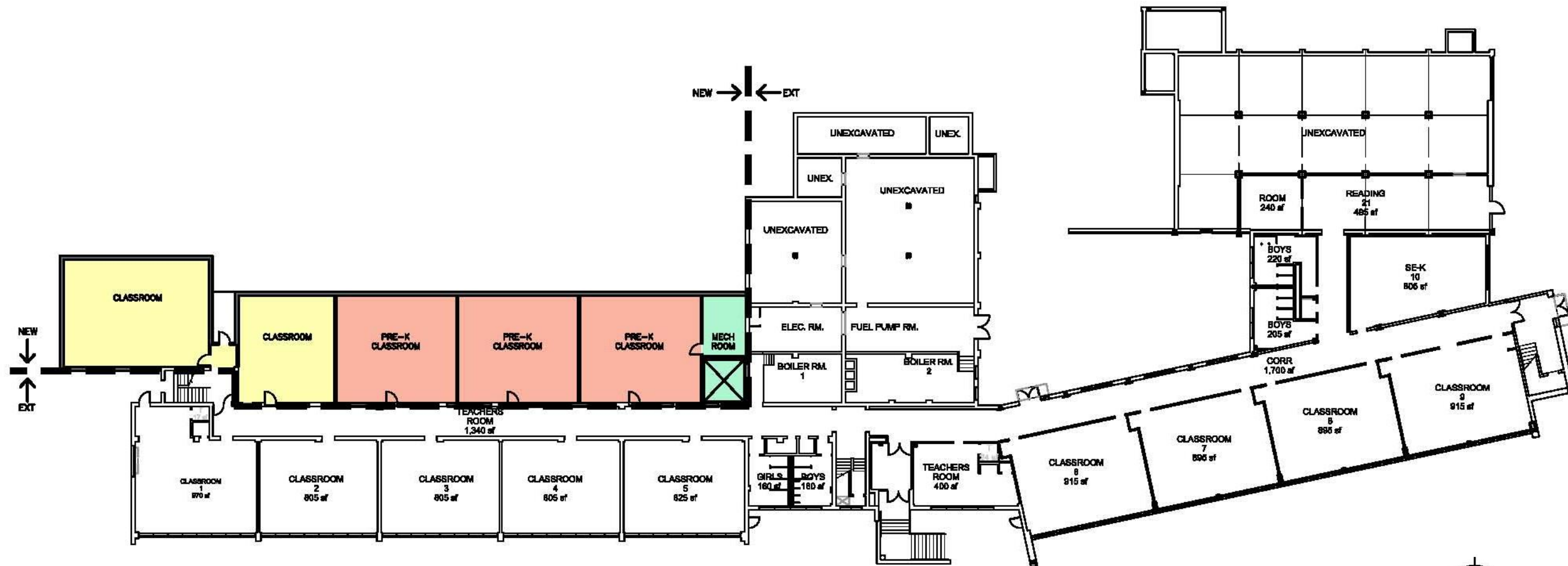

Site Plan

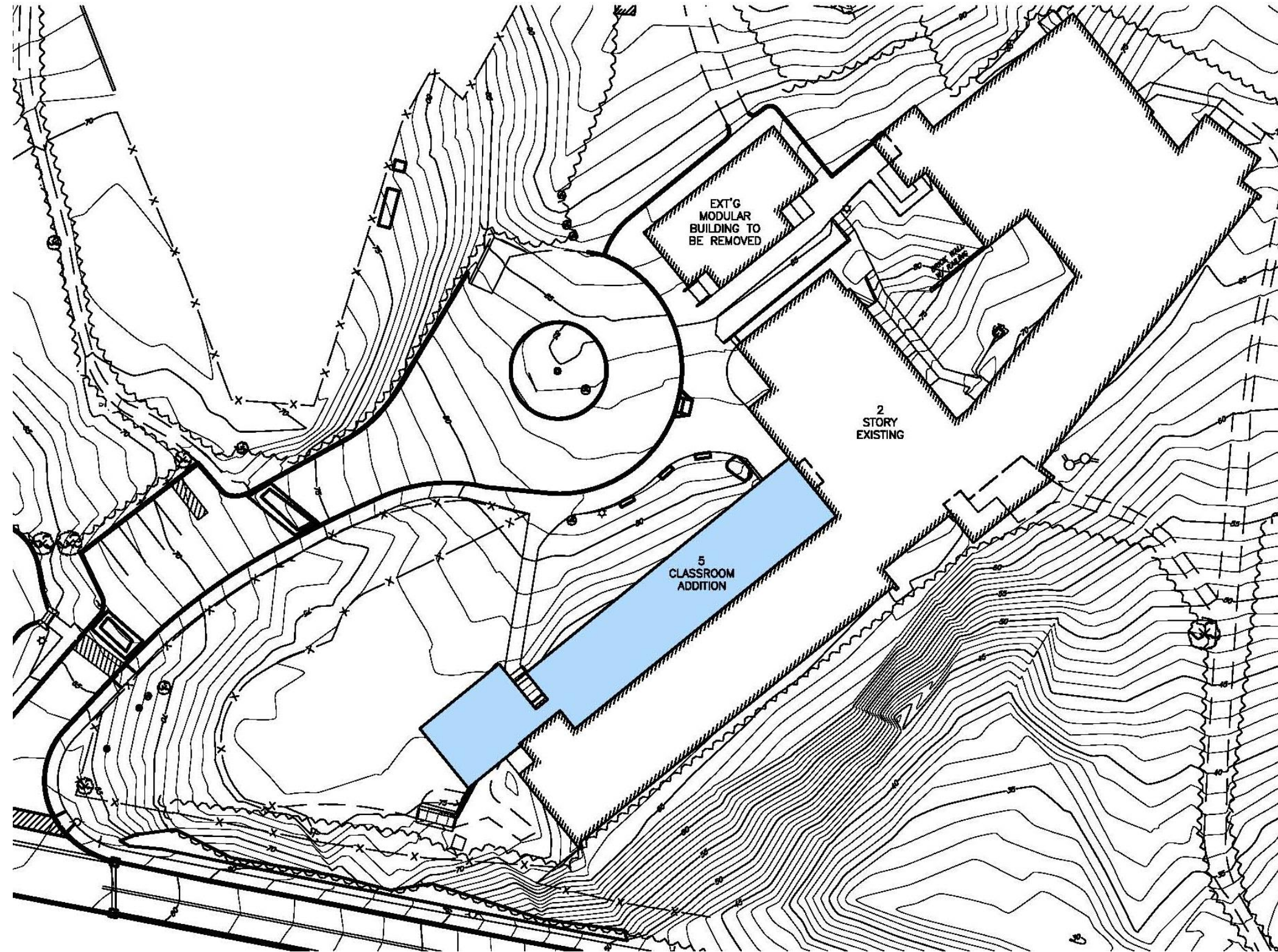

Schematic Massing Perspective



EXISTING
MODULAR
CLASSROOMS TO
BE REMOVED

5 CLASSROOM
MODULAR
ADDITION



Yonkers Public Schools: Public School 30

Project Schedule

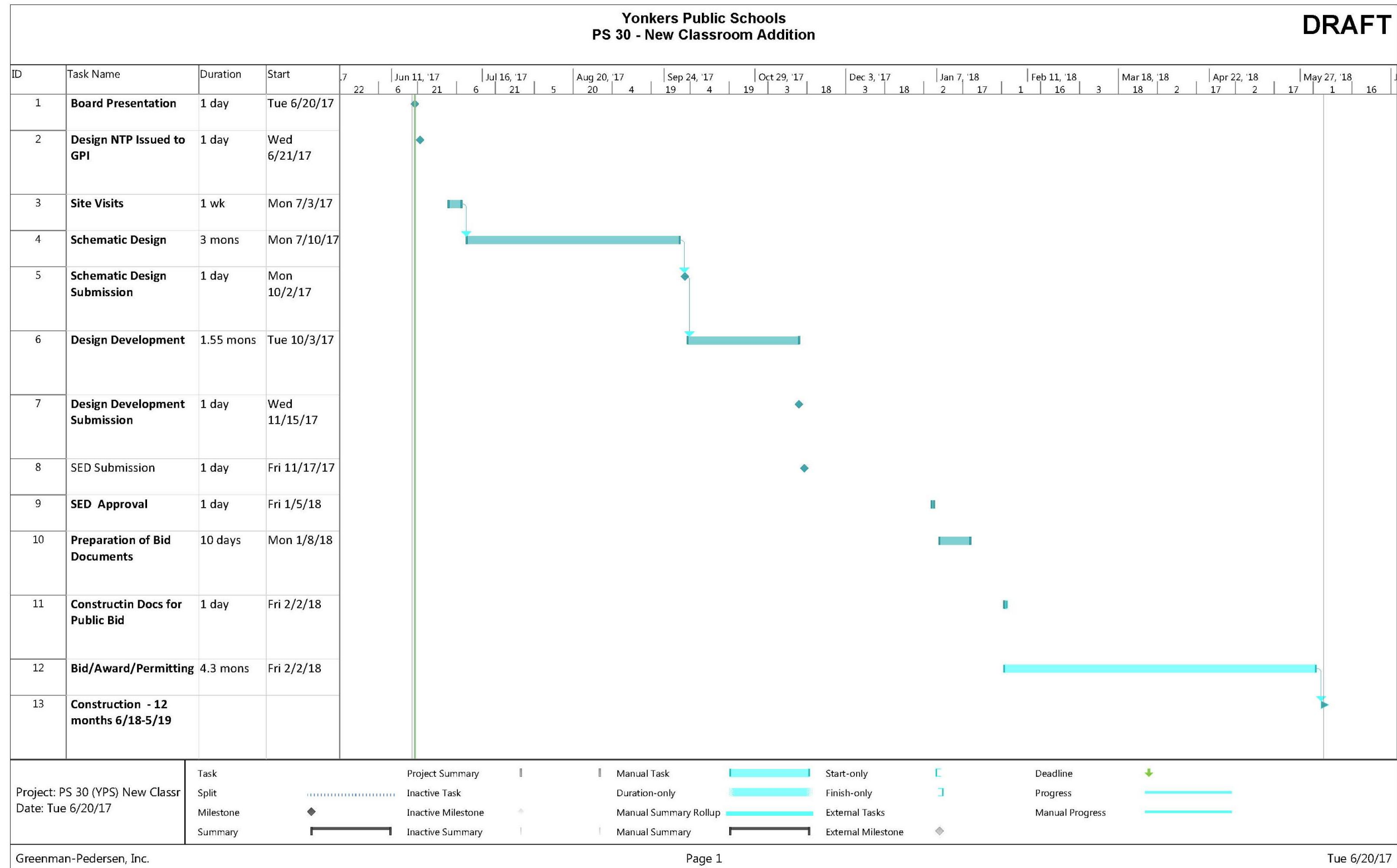

Enrollment, Budgets & State Aid

- The addition to Public School 30 will add 5 classrooms, 2 of them being general classrooms and the other 3 designated as Pre-K. This would add a total of 5,347 sf to the school.
- The initial amount is estimated to be around \$5 million. 100% of which should be reimbursable under SSBA
- The rest of the project is estimated to be around \$5 million. 70% of which should be reimbursable under normal building aid
- The total project cost is \$10 million, local share is \$1.5 million.

GPI

Greenman-Pedersen, Inc.
Engineering and Construction Services

MSA

MICHAEL SHILALE ARCHITECTS, LLP